

# CT 200

100 Watt max | 4 Ω | Ø 20 mm



► 8 Ω  
HT 200  
PAG 72

## TWEETER

Soft dome in poliammide  
Polyamide soft dome

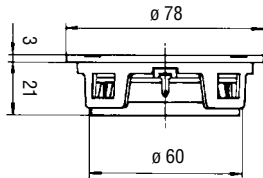

Potenza nominale	<b>60 W</b>	Re	<b>3 Ω</b>	D	<b>23 mm</b>
Impedenza nominale	<b>4 Ω</b>	Fs	<b>1 kHz</b>	Vas	-
Sensibilità (1W/1m)	<b>90 dB</b>	Qms	<b>4,7</b>	BxI	<b>2,17 Wb/m</b>
Ø bobina mobile	<b>20 mm</b>	Qes	<b>1,1</b>	Xmax	-
Altezza traferro	<b>2 mm</b>	Qts	<b>0,9</b>	η <sub>o</sub>	-
Fori di fissaggio	<b>4 x Ø 81</b>	Mms	<b>0,28 g</b>	Le	<b>0,02 mH</b>
Foro pannello	<b>70 mm</b>	Cms	-	Peso	<b>0,28 Kg</b>



48x30 cm

